



Rainwater Harvesting



IRELAND WASTE WATER also provide:

- Individually designed sewage treatment systems to suit your needs. We specialise in systems for Individual Houses, small Housing or Industrial Developments, Clubs, Caravan Parks, or whatever your need requires.
- We provide site specific requirements for planning purposes.
- Free site visits and quotations.
- Percolation tests as per E.P.A. requirements.
- All our electrical appliances come with a two year warranty.
- We provide a full after sales service.
- Annual service contracts if required.

IRELAND WASTE WATER are also specialists in the design and installation of:

- Grease Traps.
- Oil and Petrol Interceptor Traps.
- Pump Stations.

WHATEVER YOUR NEEDS CALL US WE CAN HELP

**Ireland
Waste Water**

Cloverhill, Ballymartle, Riverstick, Co.Cork.
T: 021 477 1000 • F: 021 477 1015
E: sales@irelandwastewater.ie

www.irelandwastewater.ie

Your guarantee of quality service:

Ireland Waste Water complies with Irish Agreement Board Cert No. 05/0224 and operates under the Building Regulation (Statutory Instrument 497 of 1997 to 2002) with regard to Materials and Workmanship. We also have an appropriate harmonised standard with European Technical Approval. *DIN 4261 - 1:2002 and European Standard, EN 12566-3.

CE Marking

**DIN standard is a name known worldwide. The DIN is highly regarded for its independence, neutrality, competence and long experience in the field.*

designed by Generate Studio 086-6169096

Save Money, Reduce Your Water Bills

Use rainwater instead of expensive mains water

**Ireland
Waste Water**

Cloverhill, Ballymartle, Riverstick, Co.Cork. • T: 021 477 1000 • F: 021 477 1015 • E: sales@irelandwastewater.ie • www.irelandwastewater.ie

Rainwater Harvesting

Why Harvest Rainwater?

Mains water is expensive and likely to get more expensive in the future. You can reduce your water consumption dramatically by using rain water instead of mains water for many uses.

What can Rainwater be used for?

- Industrial washing and cleaning
- General cleaning of paths and yards
- Toilet flushing in schools and industrial buildings
- Garden watering
- Washing machines



OVER 50% OF ALL WATER USED IS WASTED ON USES THAT DO NOT REQUIRE DRINKING WATER QUALITY, YOU PAY DEARLY.

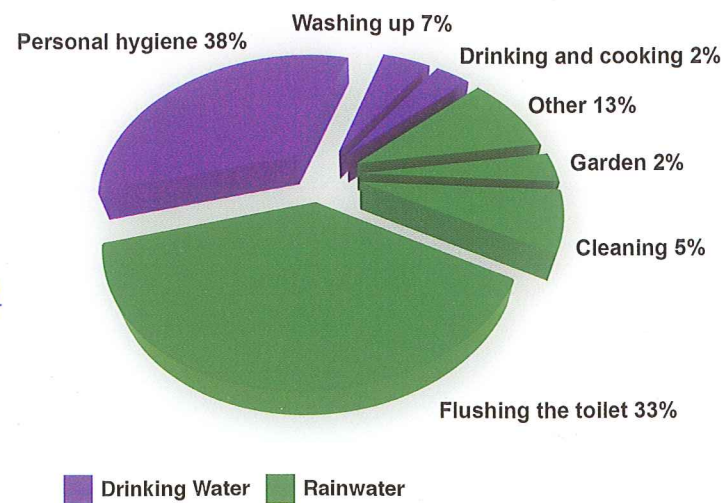

What we do

Ireland Waste Water provide a full design, delivery, and installation service. Our tanks are precast concrete giving all the advantages of stability and long life that this material brings.

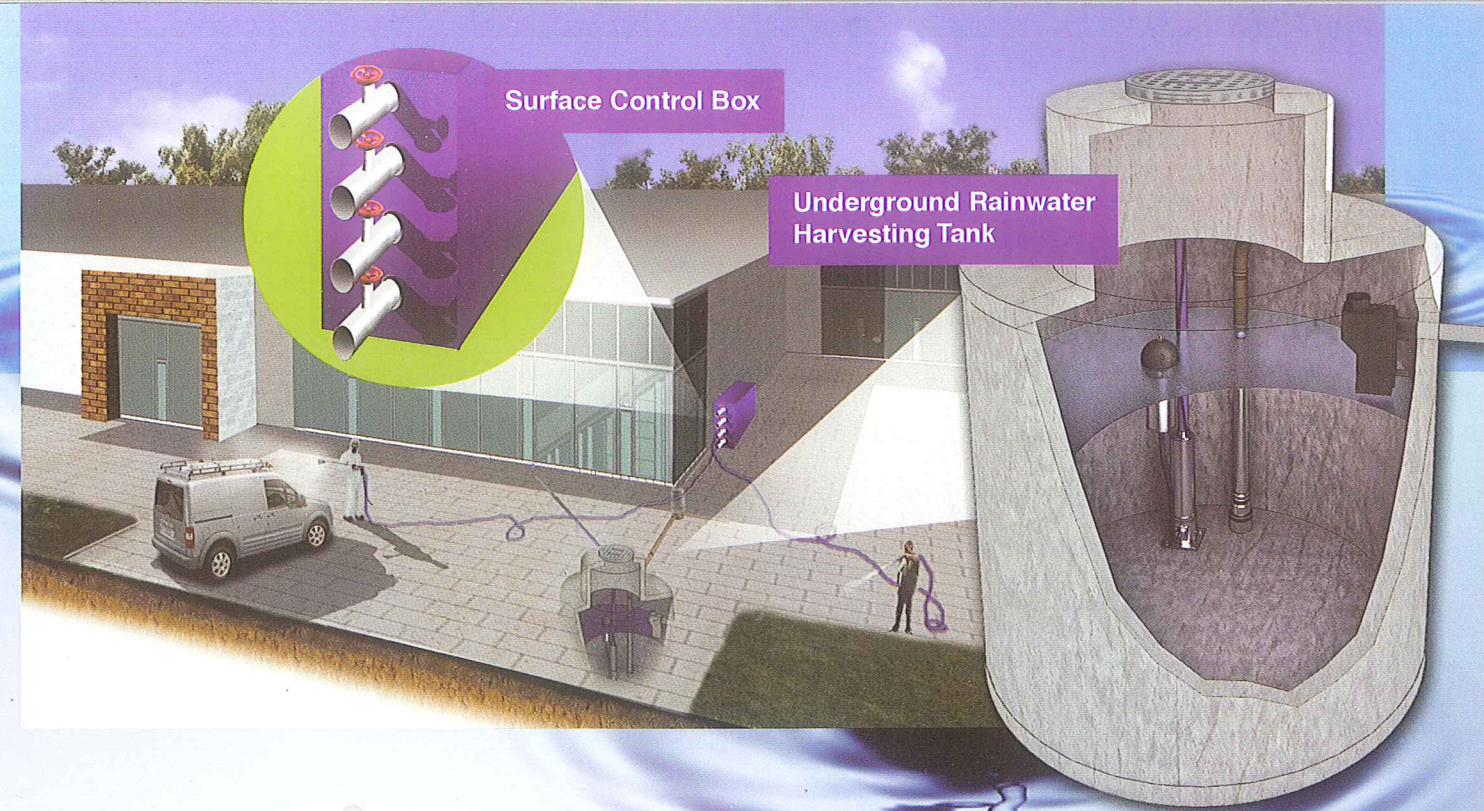

How does the system work?

1. Rain is gathered from the roofs and passes through a filter outside the underground storage tank.
2. The dirt particles and debris are separated from the water. The cleaned water flows to the tank. The dirt is washed to sewer or soak way
3. The top layer regularly overflows ensuring that any floatable material does not sour the water.
4. Water is distributed to your draw off points through the pressure valve.
5. During dry spells, if water in the tank drops below minimum levels the system will top up automatically with mains water. The volume of the tank ensures this rarely occurs.

The system requires virtually no maintenance and can easily be fitted to your existing building infrastructure.

The economic benefits

- Huge savings can be made by minimising water usage.
- Schools, Clubs and small businesses are now being hit by ever increasing water bills. Even domestic dwellings are not safe. There is every possibility that in the future that they too will face water charges.
- By introducing a rainwater harvesting system, some commercial enterprises can reduce their water bill by 85%.
- Domestic usage can be reduced by 50%.
- There is a very rapid payback period. Let our Engineer do the sums and advise you of the cost savings to be made.

The Environmental Benefits

- The more we use rainwater, the less mains water is needed to be produced at Local Authority Waterworks. This reduces the energy requirement at the works and also reduces the need to extend works or build new ones.
- The use of rainfall runoff from roofs and paved areas prevents excess water entering already overloaded sewers and soakways during periods of heavy rainfall, reducing the risk of localised flooding.

